

**25.1247.30 RR-TF30 Dr.ci.nozzle,rotat.sst 3/4F Bsp**

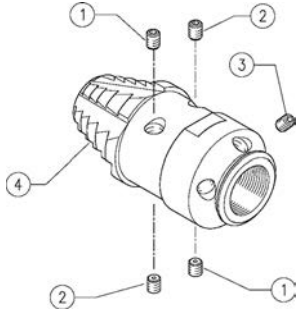

**25.1247.40 RR40 Dr.ci.nozzle,rotat,sst 3/4F Bsp**

Pos.	P/N	Description	Q.ty	K1	K2	K3	K4	
1	25.1255.51R	Nozzle, 055 - M6 Sst. (1)	2					10
1	25.1257.51R	Nozzle, 070 - M6 Sst. (2)	2					10
2	25.1251.51R	Nozzle, 025 -M6 Sst.	2					10
3	25.1252.51R	Nozzle, 035 - M6 Sst. (1)	6					10
3	25.1250.51R	Nozzle, 015 M6 Sst. (2)	6					10
4	25.1247.00R	RR00 Drain-CI.Nozzle G3/4F Sst.	1					1

(1) 25.1247.40 (2) 25.1247.30