

**25.1249.50 RR-TF50 Dr.cl.nozzle,rotat,sst 1"F Bsp**

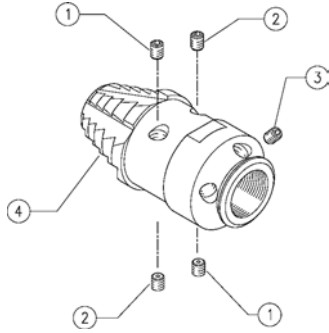

**25.1249.70 RR-TF70 Dr.cl.nozzle,rotat,sst. 1"Bsp F**

Pos.	P/N	Description	Q.ty	K1	K2	K3	K4	
1	25.1259.51R	Nozzle, 080 - M6 Sst. (1)	2					10
1	25.1255.51R	Nozzle, 055 - M6 Sst. (2)	2					10
2	25.1252.51R	Nozzle, 035 - M6 Sst. (1)	2					10
2	25.1251.51R	Nozzle, 025 -M6 Sst. (2)	2					10
3	25.1258.51R	Nozzle 075 - M6 Sst. (1)	6					10
3	25.1255.51R	Nozzle, 055 - M6 Sst. (2)	6					10
4	25.1249.00R	RR00 Rotat. Drain-Cl.Nozzle G1"F Sst. (2)	1					1
(1) 25.1249.70 (2) 25.1249.50								